

Aldreds
Estate Agents



40 Lady Margarets Avenue

Gorleston, NR31 7QW

£240,000



40 Lady Margarets

Gorleston, NR31 7QW

This beautifully presented three-bedroom end of terrace home has been modernised throughout to offer stylish and spacious accommodation ideal for families and first-time buyers alike. The property boasts a generously sized kitchen/diner, a welcoming entrance hall, and a recently fitted bathroom with separate WC, all finished to a high standard. Gas central heating and double glazing throughout provide comfort and efficiency year-round.

To the rear, the property enjoys a stunning garden and patio area, perfect for relaxing or entertaining guests. Externally, there is the added benefit of off-road parking for up to five vehicles, while excellent transport links and a range of local amenities are conveniently close by, making this a superb home in a sought-after location.

Entrance Hall

Laminate floor, double glazed door and window to front, stairs to first floor, cupboard under stairs, access to lounge and kitchen/diner, radiator.

Lounge

11'9" x 11'5" (3.60m x 3.48m)

Carpet floor, double glazed window to front, radiator.

Kitchen/Diner

22'8" x 8'8" (6.91m x 2.65m)

Tile floor, double glazed window, single door and sliding door to rear, laminate counter tops with over and under counter storage, sink and draining board, integrated oven and grill, ceramic hob with extractor fan above, space for washing machine, dish washer and fridge freezer, radiator, cupboard housing gas combi boiler.

First Floor Landing

Carpet floor, loft hatch, access to 3 bedrooms bathroom, separate WC, and cupboard.

Bedroom 1

11'8" x 11'8" (3.58m x 3.57m)

Carpet floor, double glazed windows to front, radiator.

Bedroom 2

9'10" x 10'2" (3.01m x 3.12m)

Carpet floor, double glazed window to rear, radiator, access to built in cupboard.

Bedroom 3

7'0" (8'5" into recess) x 9'8" (2.14m (2.58m into recess) x 2.96m)

Carpet floor, double glazed window to front, radiator, built in wardrobe.





Bathroom

Laminate floor, double glazed window to rear, bath tub, wall mounted shower with rainfall shower head, basin with vanity storage unit, heated towel rail.

WC

Laminate floor, double glazed window to rear, heated towel rail.

Outside Front

Combination of concrete and gravel driveway with space for 4/5 cars, brick wall and timber fence boundaries, concrete path to front door, electric vehicle charging point.

Outside Rear

Grass lawn, patio seating area, timber fence boundaries, various shrubs, outbuildings including outside WC and storage shed with power connection.

Tenure

Freehold

Services

Mains gas, water, electric, drainage.

Council Tax

Great Yarmouth Borough Council - Band B

Location

Gorleston-on-Sea is a coastal town 2 miles from Great Yarmouth centre and has a varied selection of local shops * Golf Course * Modern District hospital * Schools for all ages * Library * Regular bus services to the main shopping areas and a sandy beach.

Directions

From the Gorleston office head south along the High Street, at the traffic lights turn right into Church Lane, continue over the roundabout, at the next set of traffic lights turn left into Magdalen Way, turn left into University Crescent, turn right into Lady Margaret Avenue.

What 3 Words

///serious.soulful.derailed

Ref

G18531/05/26



Floor Plan

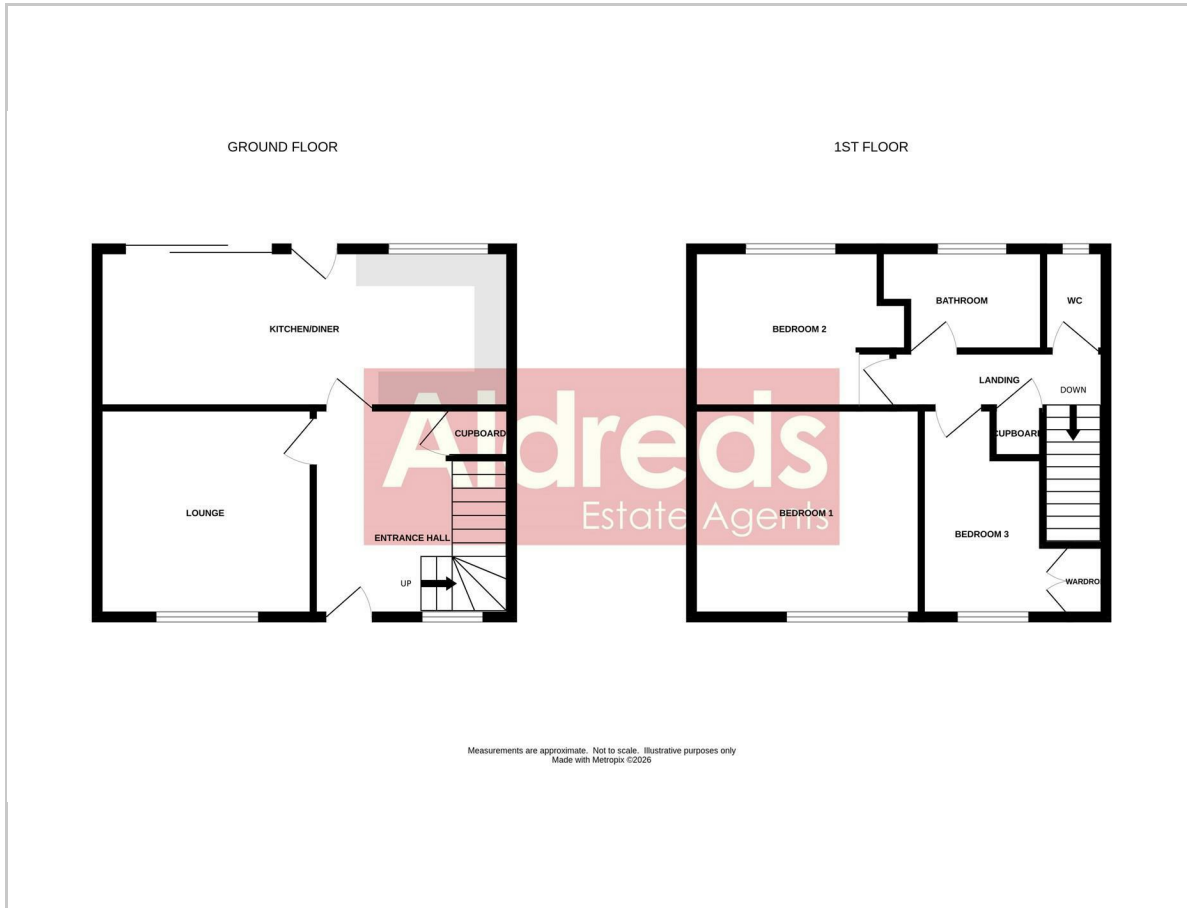

Viewing

Please contact our Aldreds Gorleston Office on 01493 664600 if you wish to arrange a viewing appointment for this property or require further information.

Disclaimer

These particulars are issued on an understanding that all negotiations shall be conducted through Messrs. Aldreds. Please note: Messrs. Aldreds for themselves and for the vendors or lessors of this property whose agents they are given notice that: 1. Particulars are set out as a general outline only for guidance of intending purchasers or lessees, and do not constitute nor constitute part of, an offer or contract. 2. All descriptions, dimensions, references to condition and necessary permissions for use and occupation, and other details are given without responsibility and any intending purchasers or tenants should not rely on them as statements or representations of fact but must satisfy themselves by inspection or otherwise as to the correctness of each of them. 3. No person in the employment of Messrs. Aldreds has any authority to make or give any representation or warranty whatever in relation to this property. 4. If you are proposing to visit the property and are travelling some distance please check with Aldreds on the issue of availability prior to travelling. 5. Aldreds Property Consultants and associated services may offer additional services to the prospective purchaser for which they will be entitled to receive a commission.

Aldreds are pleased to be working with Mortgage Advice Bureau. They're an award-winning mortgage broker with over 1,400 advisers across the UK, and have access to over 12,000 mortgage products from over 90 lenders. Aldreds Estate Agents Ltd receive a commission of £200 on each completed case. Your home may be repossessed if you do not keep up repayments on your mortgage. There may be a fee for mortgage advice. The actual amount you pay will depend upon your circumstances. The fee is up to 1%, but a typical fee is 0.3% of the amount borrowed. Mortgage Advice Bureau is a trading name of Mortgage Seeker Limited which is an appointed representative of Mortgage Advice Bureau Limited and Mortgage Advice Bureau (Derby) Limited which are authorised and regulated by the Financial Conduct Authority. Mortgage Seeker Limited Registered Office: Lovewell Blake, Sixty Six North Quay, Great Yarmouth, Norfolk, NR30 1HE. Registered in England Number: 03721415. 6. Potential purchasers should check with their providers that the broadband and mobile phone coverage they would require is available.

Area Map

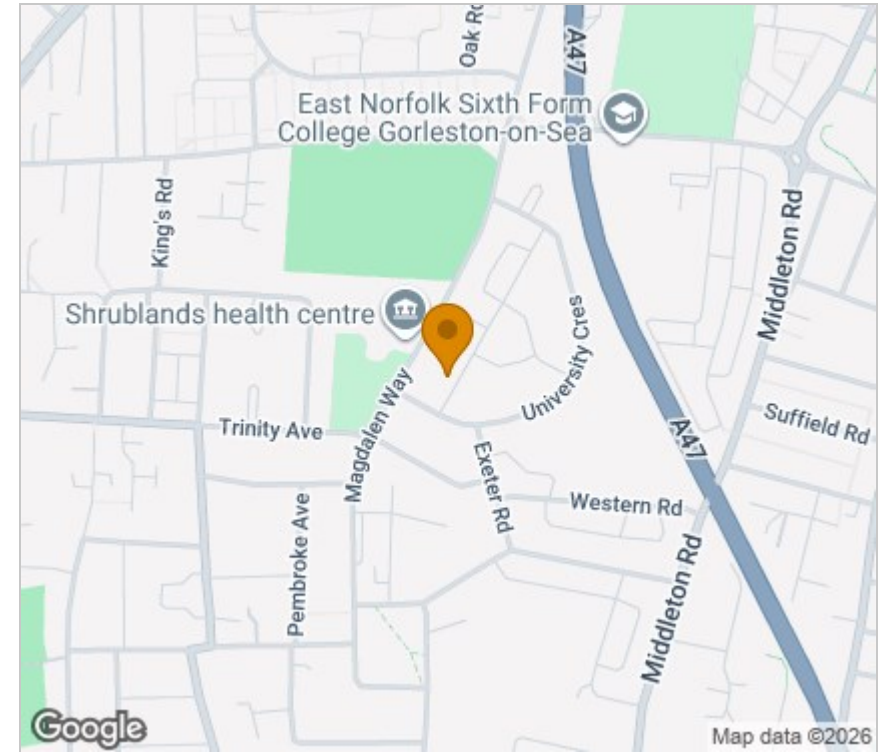

Energy Efficiency Graph

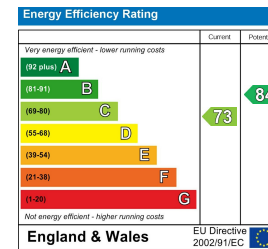

149 High Street, Gorleston, Norfolk, NR31 6RB

Tel: 01493 664600 Email: gorleston@aldreds.co.uk <https://www.aldreds.co.uk/>

Registered in England Reg. No. 08945751 Registered Office: 17 Hall Quay, Great Yarmouth, Norfolk NR30 1HJ

Directors: Mark Duffield B.S.c. FRICS. Dan Crawley MNAEA Paul Lambert MNAEA